

Housing size	M12 x 1	M12 x 1	M12 x 1	M12 x 1
Mounting type	Shield A	Shield A	Shield A	Shield A
Rated operating distance(Sn)	2mm	2mm	2mm	4mm (3.5mm)
Assured operating distance(Sa)	0...1.6mm	0...1.6mm	0...1.6mm	0...3.2mm (0...2.8mm)

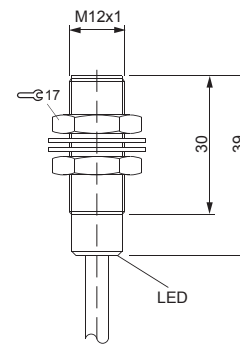

Type number	PNP	N.O.	BES516-325-E3R	BES516-325-E5R	BC5-1202P	-
		N.C.	BES516-370-E3R	BES516-370-E5R	BC5-1202P1	-
Type number	NPN	N.O.	BES516-329-E3R	BES516-329-E5R	BC5-1202N	BL3-1204N
		N.C.	BES516-375-E3R	BES516-375-E5R	BC5-1202N1	-
Rated operational voltage(Ue)			12...24V DC	12...24V DC	12...24V DC	12...24V DC
Supply voltage(Ub)			10...30V DC	10...30V DC	10...30V DC	10...30V DC
Voltage drop(Ud)			=<1.5V	=<3.5V	=<1.5V	=<2.5V
Rated operational current(Ia)			200mA	130mA	200mA	200mA
No-load supply current(Io)			=<13mA	=<20mA	=<13mA	=<13mA
Off-state current(Ir)			=<0.08mA	=<0.08mA	=<0.08mA	=<0.08mA
Circuit protection			Polarity, Short circuit	Polarity, Short circuit	Polarity, Short circuit	Polarity, Short circuit
Ambient temperature range(Ta)			-25...+70degrees C	-25...+70degrees C	-25...+70degrees C	-25...+70degrees C
Frequency of operation(f)			1000Hz	1000Hz	300Hz	400Hz
Function indication			Yes	Yes	Yes	Yes
Protection class per IEC60529			IP67	IP67	IP67	IP67
Material	Housing	Nickel plated brass		Nickel plated brass	Nickel plated brass	Nickel plated brass
	Active surface	Poly Propylen		Poly Propylen	Poly Propylen	Poly Propylen
Connection			Cable	Cable	Connector/M12	Cable
Cable	Outer sheath	PVC		PVC	-	PVC
	Diameter/core	Φ 5mm / 3 x 0.3mm <sup>2</sup>		Φ 5mm / 3 x 0.3mm <sup>2</sup>	-	Φ 5mm / 3 x 0.3mm <sup>2</sup>
	Length	2m,3m,5m		2m,3m,5m	-	2m,3m,5m
Remarks					Pin assignment of NO &NC 1 = +, 3 = -, 4 = output	The distance in () is non-flush

\*In ordering, please specify cable specification (outer sheath and length) as following example.

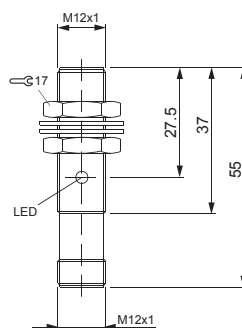
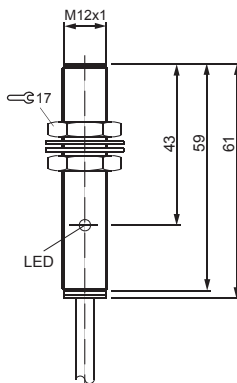
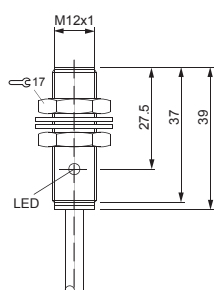
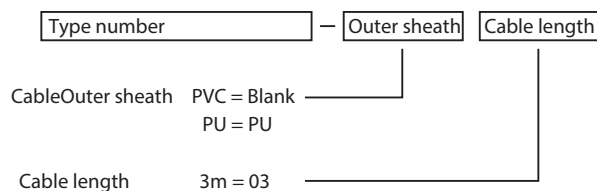

Ordering example (PVC cable 3m)

BES516-325-E3R-03