

Housing size	M30 x 1.5	M30 x 1.5	-	-
Mounting type	Shield A	Shield A	-	-
Rated operating distance(Sn)	10mm	12mm	-	-
Assured operating distance(Sa)	0...8mm	0...9.6mm	-	-

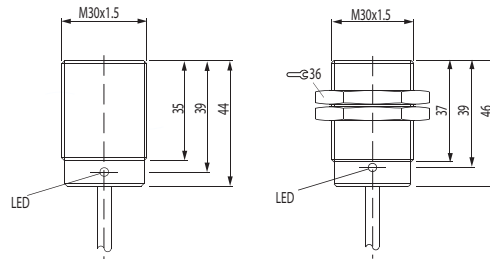

Type number	DC2W N.O. N.C.	BT3-3010D BT3-3010D1	BR5T-3012F -	-	-
Rated operational voltage(Ue)	12...24V DC	12...24V DC	12...24V DC	-	-
Supply voltage(Us)	10...30V DC	10...30V DC	10...30V DC	-	-
Voltage drop(Ud)	=<3.5V	=<3.5V	=<3.5V	-	-
Rated operational current(Ia)	4...100mA	4...100mA	4...100mA	-	-
Off-state current(Ir)	=<0.65mA	=<0.65mA	=<0.65mA	-	-
Circuit protection	Polarity, Short circuit	Polarity, Short circuit	Polarity, Short circuit	-	-
-	-	-	-	-	-
Ambient temperature range(Ta)	-25...+70degrees C	-25...+70degrees C	-25...+70degrees C	-	-
Frequency of operation(f)	300Hz	300Hz	100Hz	-	-
LED indication	Function	Function	Function, Setting	-	-
Protection class per IEC60529	IP67	IP67	IP67	-	-
Material	Housing	PTFE coated brass	PTFE coated brass	-	-
	Active surface	PTFE	PTFE	-	-
	Nut	-	Nickel plated brass	-	-
Connection	Cable	Cable	Cable	-	-
Cable	Outer sheath	PVC	PVC	-	-
	Diameter/core	Φ 5mm / 2 x 0.5mm ²	Φ 5mm / 2 x 0.5mm ²	-	-
	Length	2m,3m,5m	2m,3m,5m	-	-
Remarks	Teflon nut is available optionally.	Teflon nut is available optionally.	Cable with connector type is also available	-	-

*In ordering, please specify cable specification (outer sheath and length) as following example.

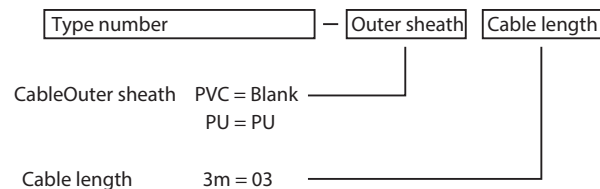

Ordering example (PVC cable 3m)

BT3-3010D-03