

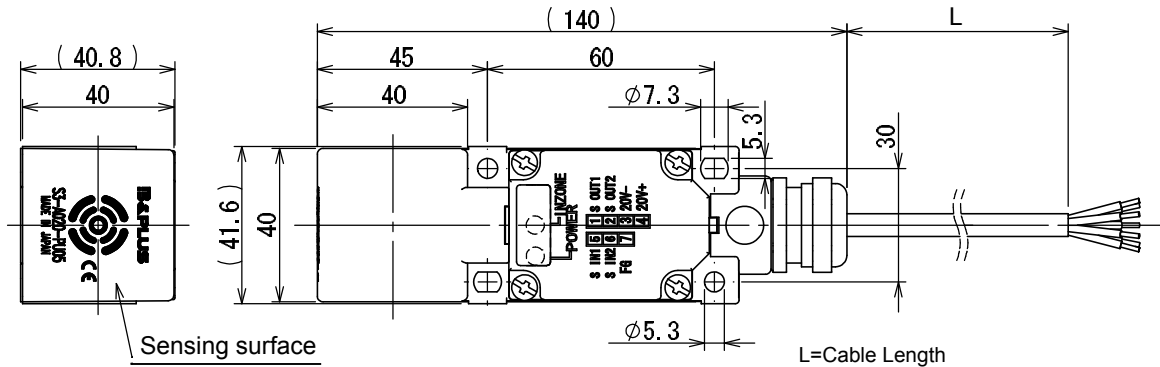

[Dimension]

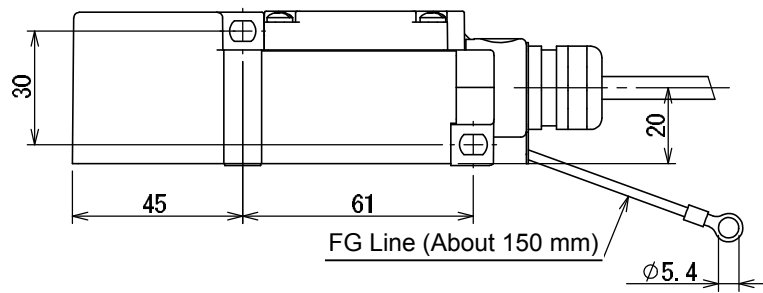

L=Cable Length
*Indicated in _ per meters at the end of the type code



Cable wiring color

| Color | Signal |
|---------------|--------|
| Black | SOUT1 |
| Black / White | SOUT2 |
| Green | SIN1 |
| Green / White | SIN2 |
| Red | 20V+ |
| Red / White | 20V- |
| Shield | FG |

[Specification]

| | |
|-------------------------|---|
| Operating temperature | 0...+70 deg.C. |
| Operating humidity | 35...90% RH |
| Storage temperature | -20...+85 deg.C |
| Storage humidity | 35...90% RH |
| Isolation | ≥ 50M Ohm (at DC500VM), case to circuit |
| Dielectric strength | 1000 VAC / 1 min. case to circuit |
| Vibration rating | 10...55 Hz, amplitude 1.5 mm 2 hrs. each axis to x-y-z. |
| Protection class | IP67 |
| Cable | PUR, Phi 6 mm 3P x 0.25 |
| Housing material | ABS |
| Weight | 250g + Cable70g / m |
| Applicable Data carrier | S1-D011-8K |

[Notes]

1. Comply with the extremely low power radio station that is determined by the Radio Law of Japan.

| Type code | S3-A020-PU_ _ | Date | 2013.01.31 | Rev. | A | Value date | 2013.01.31 | Contents. | New document. |
|-----------|---------------|--------------|------------|------|---|------------|------------|-----------|---------------|
| | | No. | D713117Ae | | | | | | |
| | | 3RD ANGLE P. | | 1/2 | | | | | |